



# Floating Shelving Installation Guide

Create your own designer look in just a few easy steps

## Each packaged Floating Shelf includes:

- One floating shelf of your chosen width and depth.
- One wall mount bracket.
- Three screws to attached the wall mount bracket onto either a wooden wall stud or for concrete and concrete block.
- Three hollow metal wall plugs for inserting into gib board.
- Three screws to attach the wall mount bracket onto gib board using the hollow wall anchor.
- Three plastic wall plugs for attaching onto concrete or concrete block.

## Basic tools for Installation

Please read all of the instructions before installation



Level

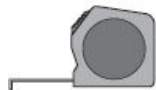

Tape measure



Hand or Power Drill



#2 Phillips Head  
Screwdriver



Drill Bits 1/8"/3mm,  
5/16"/8mm, 3/8"/10mm

## Preparations:

1. It is preferable to find a wall stud to attach the Wall-mount wall bracket
2. Hold the Wall Mount wall bracket on the wall where you want the shelf to be ensuring it is level as this is how your shelf will sit when clicked in
3. Mark the wall through the drill holes on the Wall Mount wall bracket showing where the screws are to be. Put the Wall Mount down
4. Test if your marks are also where a wall stud might be by gently drilling in one of the wall stud screws. You will know if it has hit a wall stud, as the screw will be firmer and obviously gripping something (refer [Option 1](#) on back page). Do not put the screw all the way in
5. Remove the screw and repeat this test on each of your marks
6. Where there is no grip you are screwing only into Gib Board (refer [Option 2](#) on back page)
7. For concrete or concrete block walls (refer [Option 3](#) on back page)

## OPTION ONE

### For Walls with Timber Studs

1. Position the Wall Mount on the wall
2. Where you know there is a wall stud use the wall stud screw
3. Do not tighten until all the other screws have been loosely attached
4. Gently tighten until the Wall Mount is firmly attached to the wall
5. Click on the Shelving

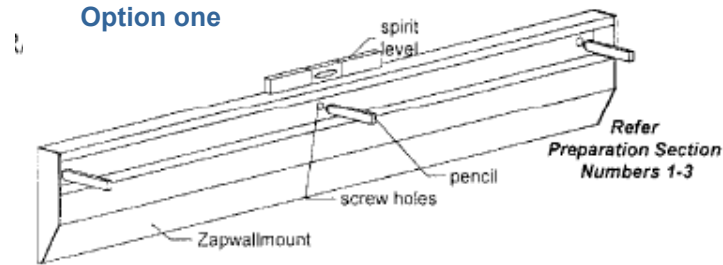

## OPTION TWO

### For Gib Board Walls

1. Use an 8mm drill bit and gently drill a hole to fit the wall anchor
2. Gently put the wall anchor in to the hole and firmly push so the face of the anchor is locked into the gib board and is sitting flat with the wall
3. Position the Wall Mount wall bracket using the three anchor screws
4. Do not tighten until all the other screws have been loosely attached
5. Gently tighten until the Wall Mount is firmly attached to the wall
6. Click on the Shelving

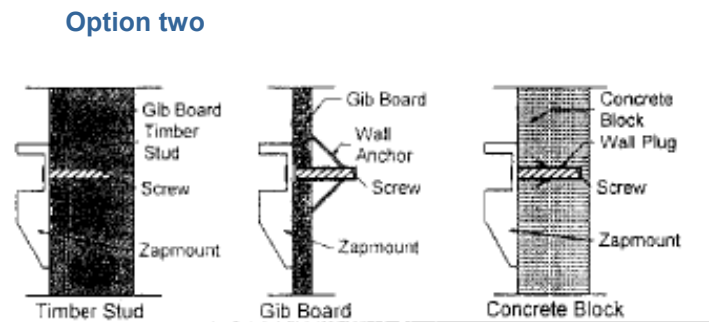

## OPTION THREE

### For Concrete or Concrete Block Walls

1. Use a 6mm masonry drill bit and gently drill a hole to fit the wall anchor. Make sure the hole is long enough to hold the screw not just the wall anchor.
2. Gently put the wall anchor in to the hole and firmly push so the face of the anchor is locked into the gib board and is sitting flat with the wall
3. Position the Wall Mount wall bracket using the three anchor screws
4. Do not tighten until all the other screws have been loosely attached
5. Gently tighten until the Wall Mount is firmly attached to the wall
6. Click on the Shelving

